

# M101AD-EX

10.1" Windows ATEX Rugged Tablet with Intel® Core™ i5-1235U



## KEY FEATURES

- Intel® Core™ i5-1235U Alder Lake processor
- 10.1" 1920 x 1200 IPS LED Panel with direct optical bonding
- Sunlight readable with antiglare solution
- Allows cross-zone operations in hazardous and explosive environments
- Ex Certificate: Class I Division 2 (CID2), ATEX/IECEX Zone 2
- USB Type C port support PD 3.0 and ALT mode

## INTRODUCTION

The Winmate ATEX Rugged Tablet Series is made for dangerous and explosive places. It provides reliable performance and supports different operating systems, like Windows and Android. Featuring sunlight-readable displays with direct optical bonding, IP65-rated protection, and MIL-STD compliance, these tablets ensure durability and usability in challenging conditions. Certified for Class I Division 2 (CID2) and ATEX/IECEX Zone 2, they enable seamless cross-zone operations. Hot-swappable batteries and versatile connectivity enhance productivity across industrial and field applications.

## SPECIFICATIONS

Display			
Resolution	1920x1200	Size	10.1 inches
Contrast Ratio	800:1	Panel Brightness	800.0 nits
View Angles	85,85,85,85	Type	Projected Capacitive Multi Touch
Viewability	Anti-Glare touch treatment	Bonding	Optical Bonding for Sunlight Viewability
System Specification			
Processor	Intel Core i5-1235U (up to 4.4GHz)	Memory	8GB DDR5 SDRAM 16GB DDR5 SDRAM (Optional) 32GB DDR5 SDRAM (Optional)
Storage	256GB M.2 NVMe SSD Additional storage available with micro SDXC card slot 512GB M.2 NVMe SSD (Optional) 1TB M.2 NVMe SSD (Optional) 2TB M.2 NVMe SSD (Optional)	Security	Trusted Platform Module (TPM) 2.0 Kensington Lock
Operating System	Windows 10 IoT Enterprise LTSC (64 bit) Windows 11 IoT Enterprise LTSC (64 bit) (Optional)	WLAN	Support
BT	Support	WWAN	4G LTE (Optional) 5G (Optional)
GNSS	GPS, GLONASS	RFID	HF RFID reader 13.56 MHz (Optional)
Sensors	Light sensor/ G-sensor / Gyro		
Camera			
Front Camera	2MP Front Camera	Rear Camera	8MP Rear Camera with auto-focus and LED light
Mechanical			
Dimension	271.5 x 198.2 x 23.3 mm	Weight	1.2 kg

**Cooling System** Fan Design

### IO Ports

<b>USB Port</b>	1 x USB 3.0 (Type A), 1 x USB 3.0 (Type-C support Power Delivery 20W In and ALT mode)	<b>SD Card Slot</b>	1 x Micro SDXC slot
<b>SIM Card Slot</b>	1 x Nano SIM card slot	<b>Audio</b>	1 x Audio combo 3.5mm audio combo jack Dual Digital Mic With Noise Cancellation Dual Speaker
<b>LAN</b>	1 x RJ45-10/100/1000 GigaLAN port	<b>Indicator</b>	4x LED Indicator for Power, Battery, HDD, RF status
<b>Docking Connector</b>	1 x 19-pin docking connector		

### Environment

<b>Operating Humidity</b>	10% to 90% RH, non-condensing	<b>Operating Temperature</b>	-10°C to 50°C
<b>Storage Temperature</b>	-30°C to 70°C (-22°F to 158°F)	<b>Shock</b>	MIL-STD-810H Method 516.8 Procedure I
<b>Vibration</b>	MIL-STD-810H Method 514.8 Procedure I	<b>IP rating</b>	IP65
<b>Drop</b>	MIL-STD-810H Method 516.8 4 ft		

### Certification

**Certification** CE, FCC  
Hazardous Location Safety:  
IECEX Class I, Zone 2, Ex ic IIC T4 Gc  
ATEX Class I, Zone 2, II 3G Ex ic IIC T4 Gc  
Class I, Division 2, Groups A, B, C, D, T4

### Security Function

<b>SOTI MobiControl</b>	SOTI MobiControl Compliance	<b>Kensington Lock</b>	Kensington Lock Support
-------------------------	-----------------------------	------------------------	-------------------------

### Control

**Button** 1 x Power, 1 x Home  
2 x volume key  
2 x Programmable function Keys

### Power

<b>Battery</b>	Hot-swappable 11.55V, typ. 4558 mAh Li-Polymer Battery (3S2P)	<b>Battery Operating Time</b>	Standard. Battery: 8 hours
<b>Power Rating</b>	19V DC	<b>Adapter</b>	100-240V, 50-60Hz / 19V DC

### Accessory

<b>Accessory</b>	Adapter and Power Cord Capacitive Stylus Standard Battery	<b>Optional Accessory</b>	Desk Dock (Optional) Vehicle Dock (without VGA output) (Optional) Vehicle Cradle (Optional) Vehicle Charger (Optional) Hand Strap (Optional) Shoulder Strap (Optional) Carry Bag (Optional)
------------------	---	---------------------------	---

### Barcode Scanner

**Barcode Scanner** 1D/2D barcode reader (Optional)

## DIMENSIONS UNIT:MM

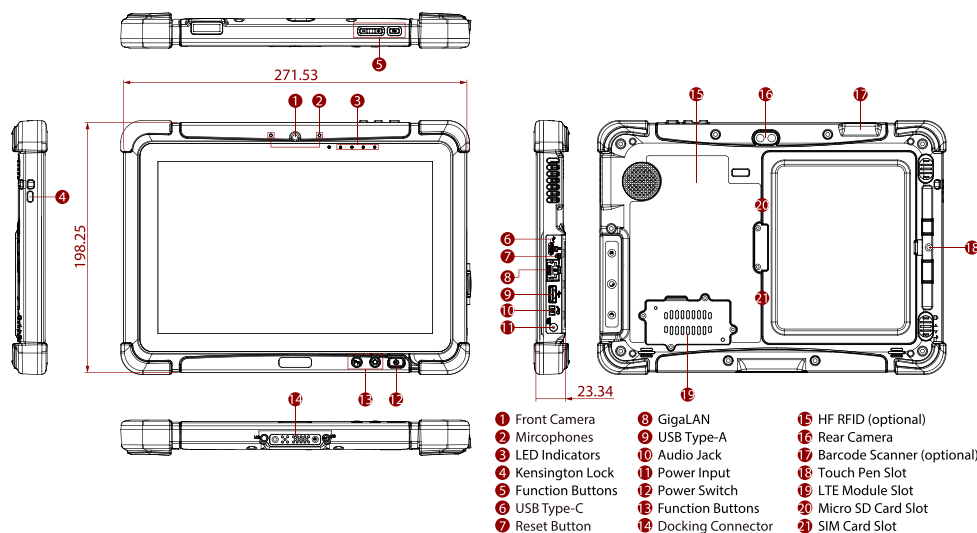

## NOTE

1. This is a simplified drawing and some components are not marked in detail.
2. Please contact our sales representative if you need further product information.
3. All specifications are subject to change without prior notice.
4. The product shown in this datasheet is a standard model. For diagrams that contain customized or optional I/O, please contact the Winmate Sales Team for more information.